

# DeckLink™

Hidden Fasteners for Conventional Deck Boards

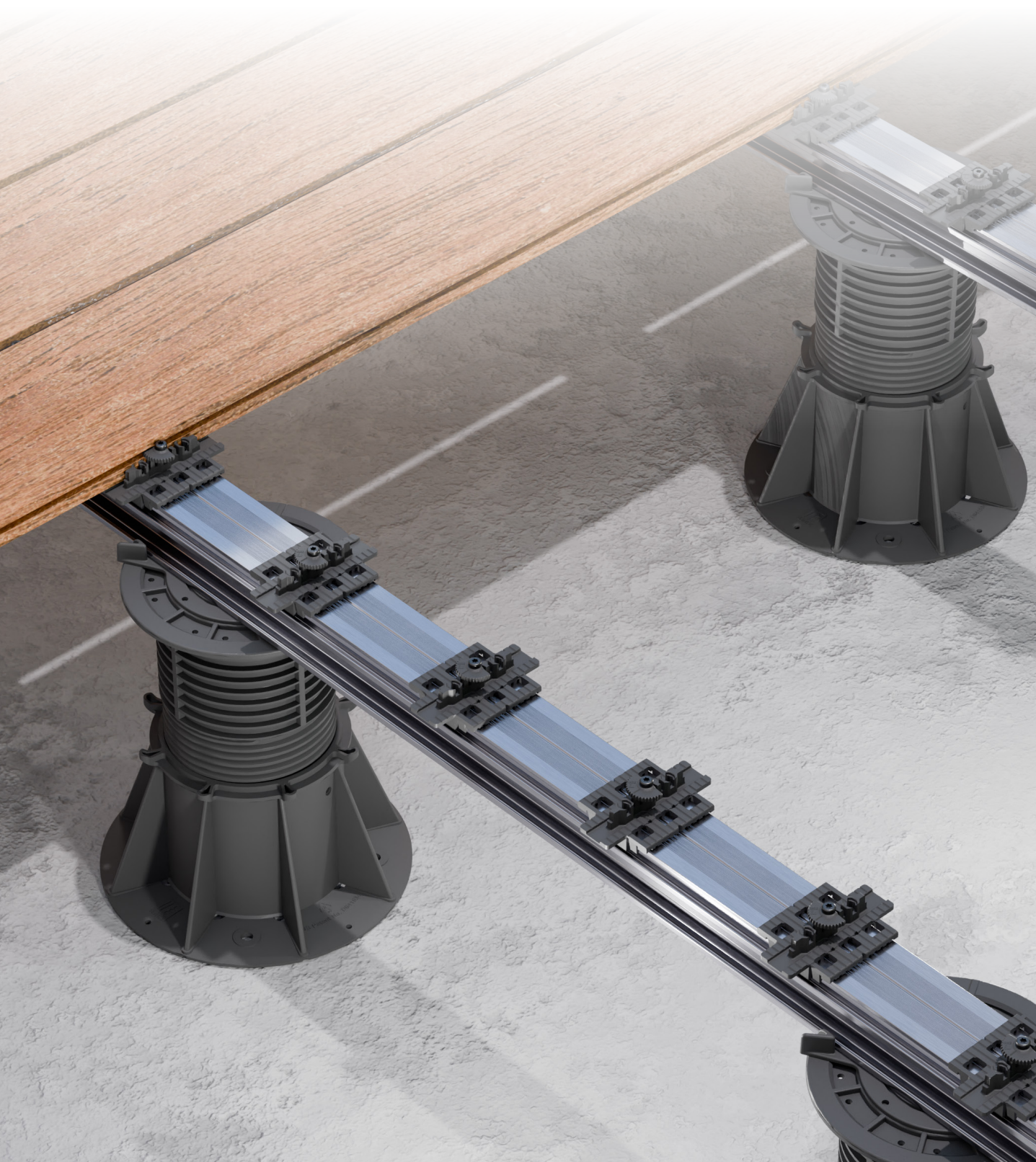

ELMICH



We make the difference.  
The Elmich Difference.

# DeckLink™

DeckLink™ is an invisible decking fastener with a screw and rotating catch for quick, easy installation and removal of deck boards. Specifically designed for decks utilising hidden fixings, it facilitates the easy removal or replacement of deck boards for maintenance and access to services beneath the deck.

## DeckLink™

DeckLink™ comprises a VF Board Holder and a Fastening Disc to secure the grooved-edge deck boards in place, concealed beneath the surface for a seamless decking finish.

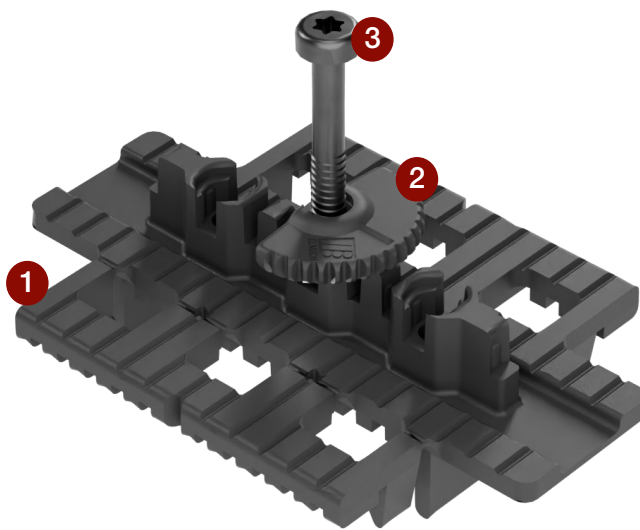

- 1 VF Board Holder
- 2 Fastening Disc
- 3 Steel Screw

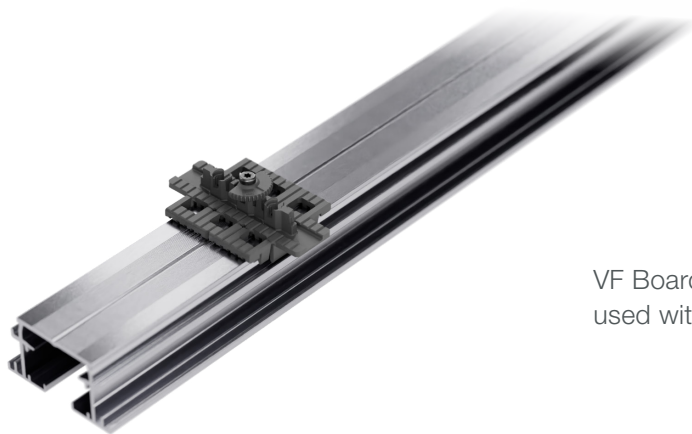

VF Board Holders and Fastening Discs are used with VersiFrame® aluminium joists.

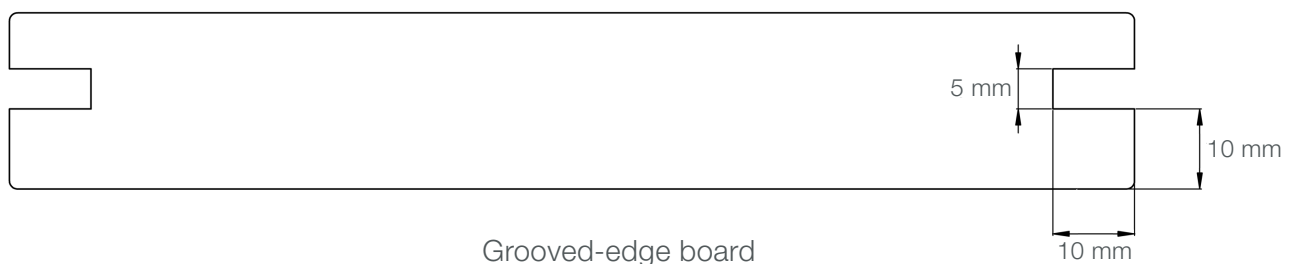



# Design Features

## Removable Boards

Boards are removed or replaced by turning the Fastening Disc through the gap between the boards.



## Abutting Boards

Twin Fastening Discs are used to secure abutting boards\* or to support a single deck board for additional stability.

*\*Boards with less expansion and shrinkage*



## End Board Holder

End clips are cut from DeckLink™ and used as both start and end clips.



## Conventional Fastening

VF Board Holder includes cut-outs for screws to affix decking boards of any profile to joists.

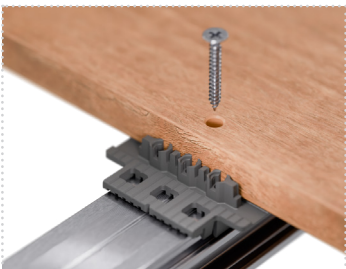

# Advantages

## Board Expansion & Contraction

DeckLink™ creates an 8 mm gap between boards to accommodate thermal expansion and contraction.

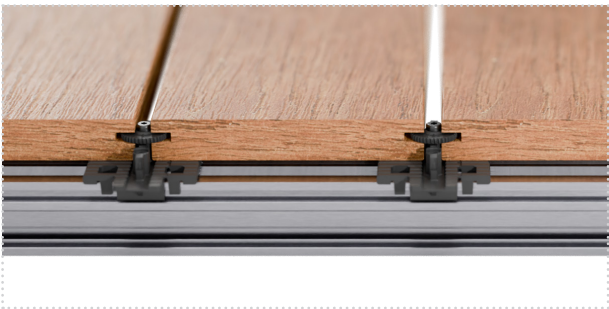

## Ventilation & Drainage

DeckLink™ creates a gap that provides airflow and drainage between the bearer and board, preventing moisture build-up, mould, and decay.

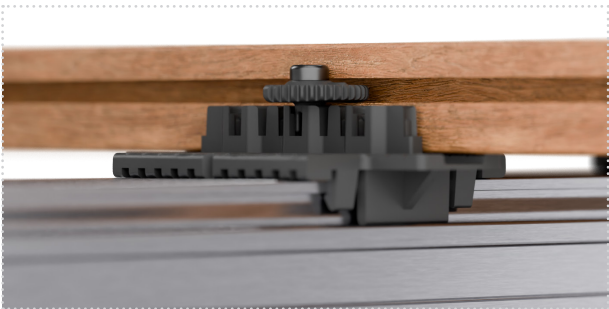

# Assembly

## Installation



Cut VF Board Holder for End Clip

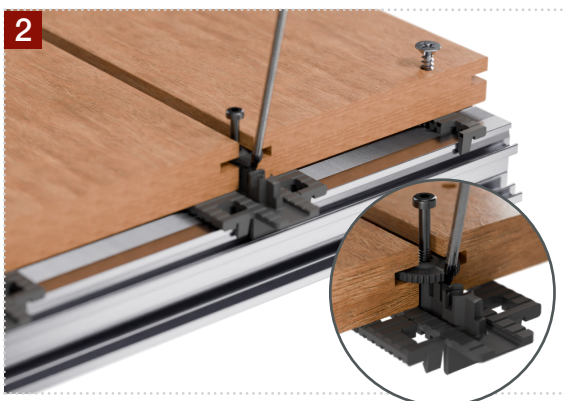

Fit board and rotate Fastening Disc

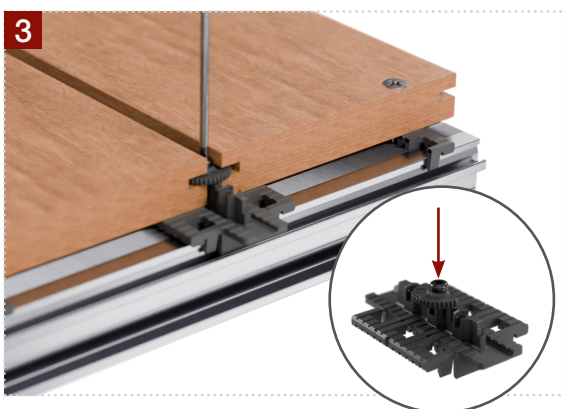

Fit all boards and tighten screw

## Removal

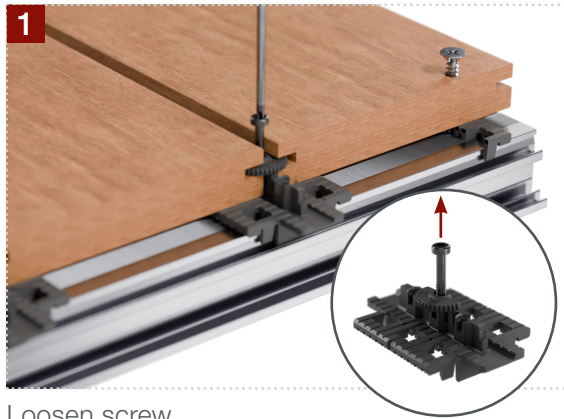

Loosen screw

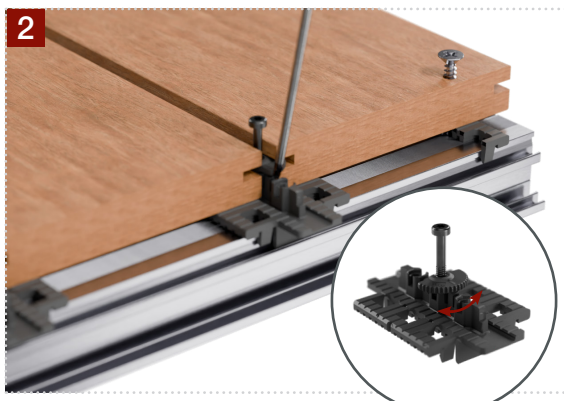

Rotate Fastening Disc

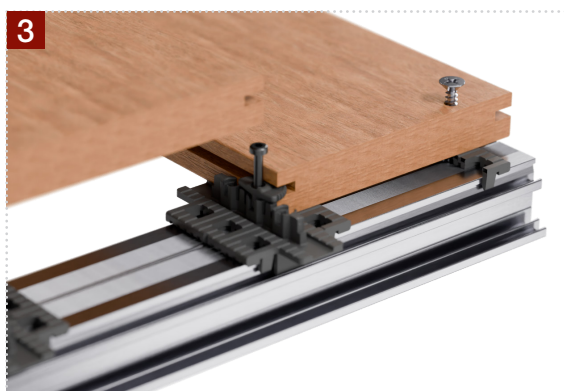

Remove individual boards



Management System  
ISO 9001:2015  
ISO 14001:2015  
ISO 22301:2019  
www.elmich.com  
ID 9105067487



SINGAPORE  
GREEN  
BUILDING  
COUNCIL  
ESTABLISHED MEMBER

SIA  
Strategic  
Partner



ENTERPRISE  
Celebrating Singapore's  
Entrepreneurial Spirit 2018

### Elmich Pte Ltd

t +65 6356 2800

e info@elmich.com

Singapore • Australia • Malaysia  
Switzerland • Germany • USA

**Note** The information provided in this brochure is based on current knowledge and experience and does not infer any legally binding assurance or warranty, expressed or implied. Intending purchasers should verify whether any changes to specifications or applications or otherwise have been made since the issue of this literature. Environmentally-friendly recycled materials are used in product manufacture wherever possible. Physical product properties including colour may differ due to source of raw materials used. Colour may also fade due to UV exposure. All components of the product are designed for specific application, design calculations and any variation and/or deviation therefrom shall be the responsibility of the specifier and/or user.